

PESH[®]

Syringe sampling valve with membrane for process tanks or lines and low-viscosity liquids

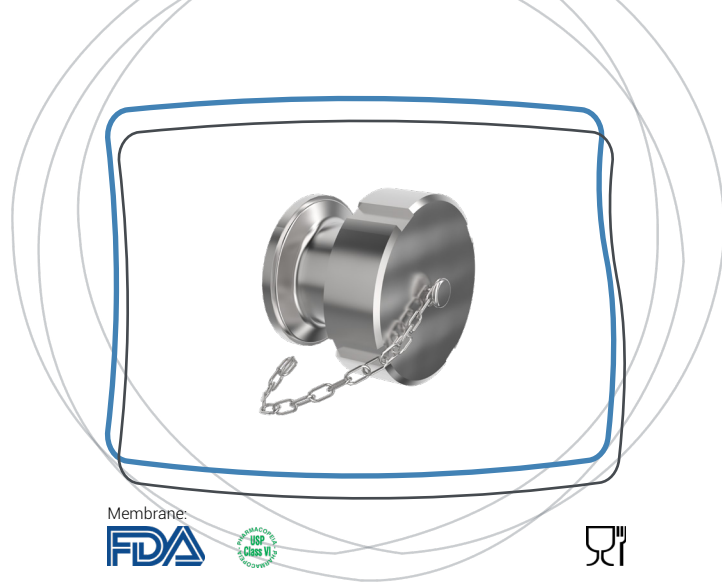

Presentation

The PESH sampling valve is used to take a sample of clear or low-viscosity liquid from a tank or a transfer circuit, in order to carry out quality and/or bacteriological tests. Its reinforced hygienic design ensures that there are no retention areas (where bacteria can develop), and that it is easy to clean. The sample is taken using a syringe through a self-repairing membrane. A numbered grid on the front panel of the equipment identifies which areas have already been used and which are still available for sampling.

Key features

- Syringe sampling
- Hygienic design, with the option of flush mounting (eq. NA Connect® or VARIVENT mounting support)
- Easy maintenance, only the membrane needs to be replaced
- Indexing for use of one hole per sample, to avoid any risk of contamination from the sampling point

Applications

- Process tanks or transfer lines containing clear, bacteriologically sensitive liquids
- Equipment particularly suited to sampling products subject to quality and/or bacteriological tests (particularly for the dairy industry)

Technical features

Connection: Clamp with an outside diameter of 50.5 mm

Mounting on minimum OD 1" connection (inside diameter 22.1 mm)

Operating pressure: from -1 to 10 bar for OD 1"

Operating temperature: from 1°C to 130°C

Withstands CIP/SIP: up to 140°C for 20 to 30 minutes

Indexed grid: 15 holes, diameter 2.5 mm

Materials

- Stainless steel 1.4404 (316L)
- Self-repairing membrane: VMQ (Silicone)

Dimensions in mm

PESH only

Sizes	ØA	B
Dimension	50.5	52

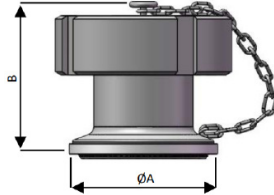

Mounting on N/A connect flange

Sizes	ØA	B
Dimension	85	58

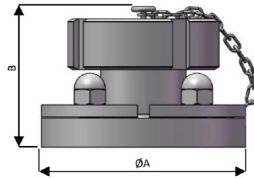

Mounting on TC00203 flange

Sizes	ØA	B
Dimension	109.5	60

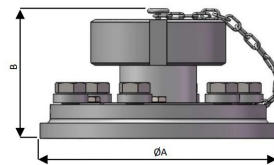

Options

- Supply of NA Connect® flange or equivalent
- PESH delivered mounted on pipe section (integrated clamp support)

Warranty

12 months as from the date of dispatch (except for special conditions)

Conformity

- Pipe fitting and tank compliant with Paragraph 4.3 of the PED 2014/68/EU
- Elastomer membrane compliant with FDA CFR 21.177.2600, Regulation (EC) 1935/2004 and USP Class VI

Non-contractual document and visuals, subject to change without notice.

Only the commercial offer and the technical manual supplied with the equipment may be used for technical and legal purposes.